



www.thefleetwoodmackexperience.co.uk

- Tech Spec -

The Fleetwood Mack Experience

- Stage Plan -

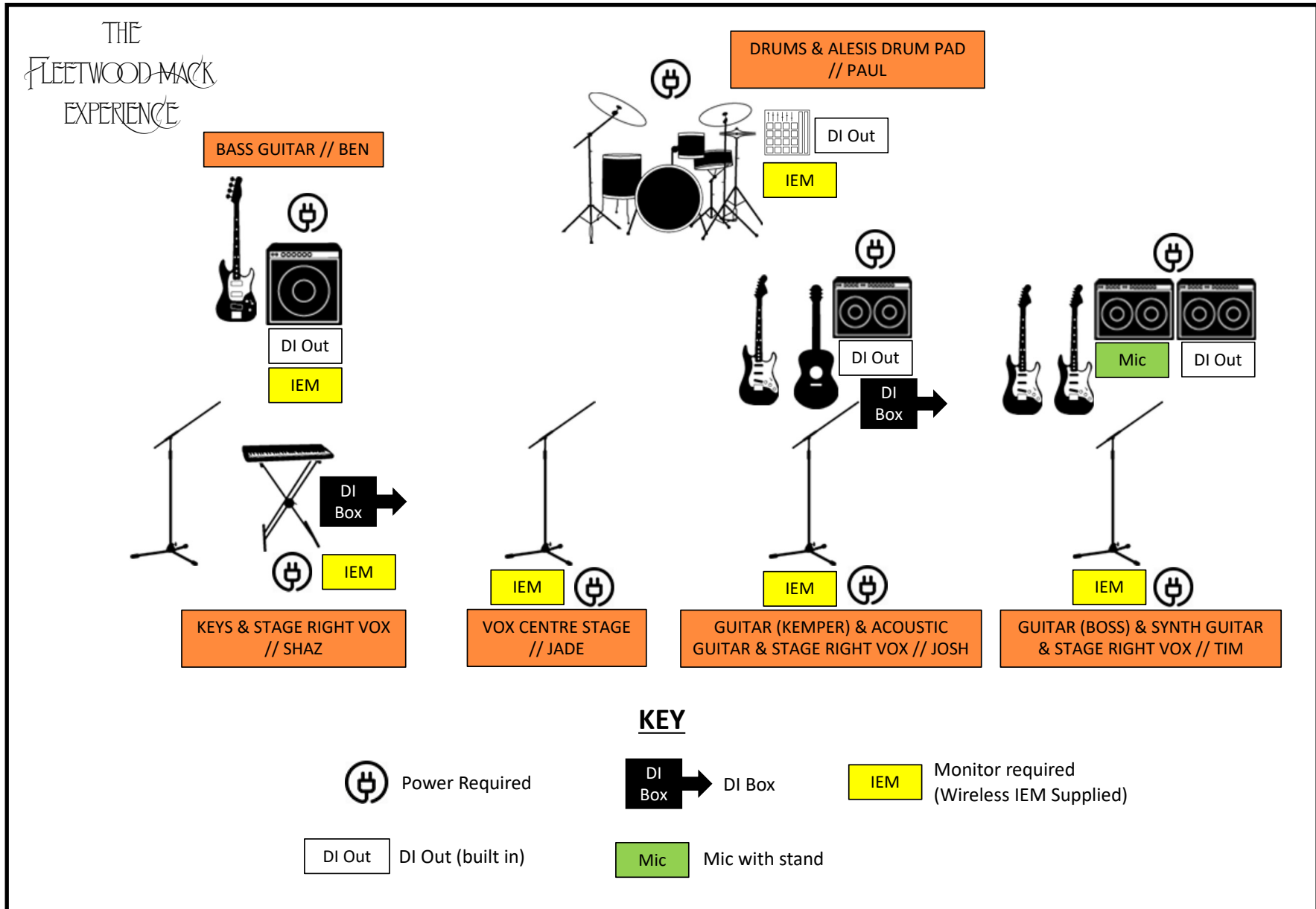

The Fleetwood Mack Experience

- Instrument Input -

| Desk Input | Instrument/Input | Description | Mic/DI | Stands Required | Band Member |
|------------|-----------------------|----------------------------|-------------|-----------------|-------------|
| 1 | Kick Drum | | Mic | | Paul |
| 2 | Snare Drum | | Mic | | |
| 3 | Hi-Hat | | Mic | Tall Boom | |
| 4 | Rack Tom 1 | | Mic | | |
| 5 | Rack Tom 2 | | Mic | | |
| 6 | Floor Tom | | Mic | | |
| 7 | Overhead Left | | Mic | Tall Boom | |
| 8 | Overhead Right | | Mic | Tall Boom | |
| 9 | Drum Pad | Alesis Strike Multi Pad | DI mono out | | |
| 10 | Bass Guitar | Boss Katana 210 Bass Amp | DI mono out | | Ben |
| 11 | Electric Guitar | Kemper Guitar Head | DI mono out | | Josh |
| 12 | Acoustic Guitar | Direct from guitar, no amp | DI mono out | | |
| 13 | Electric Guitar | Boss Katana Guitar amp | Mic | Small Boom | Tim |
| 14 | Guitar Synth | Acoustic Guitar Amp | DI Mono out | | |
| 15 | Keyboard | Roland Keyboard | DI mono out | | Shaz |
| 16 | Vox - Stage Right | SM58 | Mic | Tall Boom | Shaz |
| 17 | Vox - Stage Centre | SM58 | Mic | Tall Boom | Jade |
| 18 | Vox - Stage Left | SM58 | Mic | Tall Boom | Josh |
| 19 | Vox - Stage Left (BV) | SM58 | Mic | Tall Boom | Tim |

The Fleetwood Mack Experience

- Monitors -

| Aux Send | Band Member | In-Ear Monitor | Description |
|-----------------|--------------------|-----------------------|----------------------------|
| 1 | Jade | DI mono in | Wireless In-Ear (Supplied) |
| 2 | Josh | DI mono in | Wireless In-Ear (Supplied) |
| 3 | Shaz | DI mono in | Wireless In-Ear (Supplied) |
| 4 | Tim | DI mono in | Wireless In-Ear (Supplied) |
| 5 | Ben | DI mono in | Wireless In-Ear (Supplied) |
| 6 | Paul | DI mono in | Wired In-Ear |